



Supervisor Collaboration Agenda: Baton Rouge Tuesday, November 13, 2018

The Supervisor Collaboration events will provide school system supervisors with information about the Department's priorities and access to high-quality tools and resources focused on supporting schools in 2018-2019 and planning for 2019-2020.

Location:

Claiborne Building
1201 North Third St.
Baton Rouge, LA 70806

Parking:

Parking is available in the lot in front of the Claiborne Building or along the levee. Do not attempt to park in the garage behind the building; this is for state employees only and requires a key card for entry. Parking is limited. Please consider carpooling and leave extra time to walk to the building.

Agenda:

8:00- 8:30 Sign-in
8:30- 9:00 Opening: School System Planning 2019-2020 and Super App Launch
9:00- 9:30 2017-2018 Accountability Results Release
9:45-11:00 Rotation 1: School System Planning Resources
(**universal content, groups begin to rotate**)
11:10-12:10 Rotation 2: Choice Session
12:10- 1:10 **LUNCH**
1:10- 2:10 Rotation 3: Choice Session
2:20- 3:20 Closing: Completing a Super App, Timeline, and Guidance
(**universal content, groups rotate back to Rotation 1 site**)

Preparation

All participants should **bring a fully charged laptop computer** with them to the event and [download session materials in advance](#).

Food and Hotels

Food will *not* be provided at the event. Click here for a list of [Baton Rouge area hotel and food options](#).

Contact Us

Please contact your Network support team or DistrictSupport@la.gov with questions about this event.



Sessions

Participants will have the opportunity to choose **two** sessions that fit their needs and interests, beginning with Rotation 2. Attendees from each school system should coordinate with one another to ensure they get all the necessary information. Attendees will *not* register for specific sessions in advance. All sessions are filled on a first come, first served basis. All information in the table below is subject to change.

Session Topics	Session Title	Session Description	Audience/Room
OPENING			
School Improvement	School System Planning 2019-2020 and Super App Launch	All participants will join this session to learn about the improved school system planning process for 2019-2020 and the 'Super App', the new application in which school systems will submit improvement plans.	All: Louisiana Purchase Room 1-100
Accountability	2017-2018 Accountability Results Release	The Department will provide a briefing on 2017-2018 school and center performance results, released at www.LouisianaSchools.com on November 8.	All: Louisiana Purchase Room 1-100

NOTES:

Session Topics	Session Title	Session Description	Audience/Room		
ROTATION 1					
School Improvement	School System Planning Resources	All participants will join this session to increase understanding of the new school system planning process by reviewing and analyzing a key Super App planning tool, the School System Planning Framework.	<u>Louisiana Purchase</u> Avoyelles Baker City of Bogalusa City of Monroe EBR8 East Feliciana Evangeline Iberville OJJS Pointe Coupee SSD St. Charles St. Helena St. Martin Tangipahoa West Baton Rouge West Feliciana <i>All others not listed.</i> <u>Thomas Jefferson 1-136 A</u> Ascension Assumption Calcasieu St. John St. Landry St. Mary Vermillion	<u>Thomas Jefferson 1-136 B</u> Charters Democracy Prep Advance BR Algiers Celerity Central/Community Schools CSUSA LA Virtual Delta Impact Friendship Academy GEO JCFA LSDVI Southern Lab Smothers BR College Prep APEX JS Clark Kenilworth Slaughter Tangi Academy Einstein University Academy of Central University View Academy	<u>Iowa 1-153</u> Concordia Franklin LaSalle Lincoln Livingston Madison Ouachita Richland Sabine St. Tammany Tensas Zachary <u>North Dakota 1-155</u> Acadia Iberia Lafayette Lafourche Rapides Washington

Note: All of the session information in this table is subject to change.

Session Topics	Session Title	Session Description	Audience/Room
ROTATION 2			
Academic Content	Supporting Students Who Struggle in ELA	Join this session to dig deeper into the framework, tools, and specific approaches to support students who struggle in ELA.	Thomas Jefferson Room 1-136 A
Academic Content	Supporting Students Who Struggle in Math	Join this session to dig deeper into the framework, tools, and specific approaches to support students who struggle in math. Participants will analyze the findings from the 2017-2018 Intensive Algebra I pilot and learn how to apply the findings from that pilot to other grade levels.	Iowa Room 1-153
Federal Programs	Preparing for Super App	This training will provide technical assistance to those who will be responsible for submitting the LEA's Super App in eGMS.	Louisiana Purchase Room 1-100
Student Opportunities	Behavioral Intervention Redesign: A New Model for Student Support and Success	In this session, participants will learn about the toolbox of resources to support schools identified as Urgent Intervention for discipline. Participants will receive an overview of how the new resources support evidence based behavioral intervention, as well as details on how to select and implement interventions based upon the schools' specific student population and needs.	North Dakota Room 1-155
Student Opportunities	HS Pathways and Jump Start 2.0	In this session supervisors will review the most recent TOPS University and Jump Start Statewide Pathway requirements and understand how the Jump Start 2.0 process can improve industry alignment, rigor, and equitable access of IBCs.	Marbois Room 1-137
Talent	Building Your School System's Leadership Pipeline	In this session supervisors will begin the strategic planning necessary to build leadership pipelines in their districts. Using workforce data participants will identify areas of needs in their current leadership pipelines. Participants will then have an opportunity to build their understanding of current statewide initiatives including Principal Fellowship, Content Leaders, and Mentor Teacher designed to support leadership pipelines and draft a plan for how they will leverage these supports.	Napoleon Bonaparte Room 1-165

Note: All of the session information in this table is subject to change.

Session Topics	Session Title	Session Description	Audience/Room
Talent	Workforce Talent in the Super App	In this session, school systems will use workforce data to develop plans in Super App, prioritizing workforce talent strategies for their persistently struggling schools. NOTE: Participants should bring a charged laptop to the session and be prepared to log into the secure portal to access your educator workforce data.	Thomas Jefferson Room 1-136 B
Talent	Believe and Prepare: Educator Preparation (Teacher Preparation Accountability)	The purpose of this session is to solicit feedback from teacher preparation providers regarding the index for the Teacher Quality domain.	Montana Room 1-142
ROTATION 3			
Academic Content	Supporting Students Who Struggle in ELA	Join this session to dig deeper into the framework, tools, and specific approaches to support students who struggle in ELA.	Louisiana Purchase Room 1-100
Academic Content	Supporting Students Who Struggle in Math	Join this session to dig deeper into the framework, tools, and specific approaches to support students who struggle in math. Participants will analyze the findings from the 2017-2018 Intensive Algebra I pilot and learn how to apply the findings from that pilot to other grade levels.	Iowa Room 153
Federal Programs	Preparing for Super App	This training will provide technical assistance to those who will be responsible for submitting the LEA's Super App in eGMS.	Thomas Jefferson Room 1-136 A
Student Opportunities	Behavioral Intervention Redesign: A New Model for Student Support and Success	In this session, participants will learn about the toolbox of resources to support schools identified as Urgent Intervention for discipline. Participants will receive an overview of how the new resources support evidence based behavioral intervention, as well as details on how to select and implement interventions based upon the schools' specific student population and needs.	Thomas Jefferson Room 1-136 B

Note: All of the session information in this table is subject to change.

Session Topics	Session Title	Session Description	Audience/Room
ROTATION 3 CONT'D			
Student Opportunities	John Hopkins Cohort	In this session, participants will review the objectives and key milestones related to the Johns Hopkins High School Redesign Cohort. Thirty high schools--alternative and traditional--have engaged in a collaborative, including members of LDOE and Johns Hopkins University, that focused on four key levers of school redesign and accompanying strategies. Members of the cohort were tasked with reimagining both school structure and services to maximize positive student outcomes, and facilitate high schools preparing students for post-secondary education and careers.	Colorado Room 1-141
Student Opportunities	HS Pathways and Jump Start 2.0	In this session supervisors will review the most recent TOPS University and Jump Start Statewide Pathway requirements and understand how the Jump Start 2.0 process can improve industry alignment, rigor, and equitable access of IBCs.	Marbois Room 1-137
Talent	Building Your School System's Leadership Pipeline	In this session supervisors will begin the strategic planning necessary to build leadership pipelines in their districts. Using workforce data participants will identify areas of needs in their current leadership pipelines. Participants will then have an opportunity to build their understanding of current statewide initiatives including Principal Fellowship, Content Leaders, and Mentor Teacher designed to support leadership pipelines and draft a plan for how they will leverage these supports.	North Dakota Room 1-155
Talent	Workforce Talent in the Super App	In this session, school systems will use workforce data to develop plans in Super App, prioritizing workforce talent strategies for their persistently struggling schools. NOTE: Participants should bring a charged laptop to the session and be prepared to log into the secure portal to access your educator workforce data.	Napoleon Bonaparte Room 1-165

Note: All of the session information in this table is subject to change.

Session Topics	Session Title	Session Description	Audience/Room		
CLOSING					
School Improvement	Completing a Super App: Timeline and Guidance	All participants will join this session to learn about the actions required of districts to prepare their Super App. The planning process begins in November and concludes on February 1 when Super Apps are due. Specific tools and guidance about completing the Super App planning process will be provided at this session.	<u>Louisiana Purchase</u> Avoyelles Baker City of Bogalusa City of Monroe EBR8 East Feliciana Evangeline Iberville OJJS Pointe Coupee SSD St. Charles St. Helena St. Martin Tangipahoa West Baton Rouge West Feliciana All others not listed.	<u>Thomas Jefferson 1-136 B</u> Charters Democracy Prep Advance BR Algiers Celerity Central/Community Schools CSUSA LA Virtual Delta Impact Friendship Academy GEO JCFA LSDVI Southern Lab Smothers BR College Prep APEX JS Clark Kenilworth Slaughter Tangi Academy Einstein	<u>Thomas Jefferson 1-136 B cont'd</u> University Academy of Central University View <u>Iowa 1-153</u> Concordia Franklin LaSalle Lincoln Livingston Madison Ouachita Richland Sabine St. Tammany Tensas Zachary <u>North Dakota 1-155</u> Acadia Iberia Lafayette Lafourche Rapides Washington

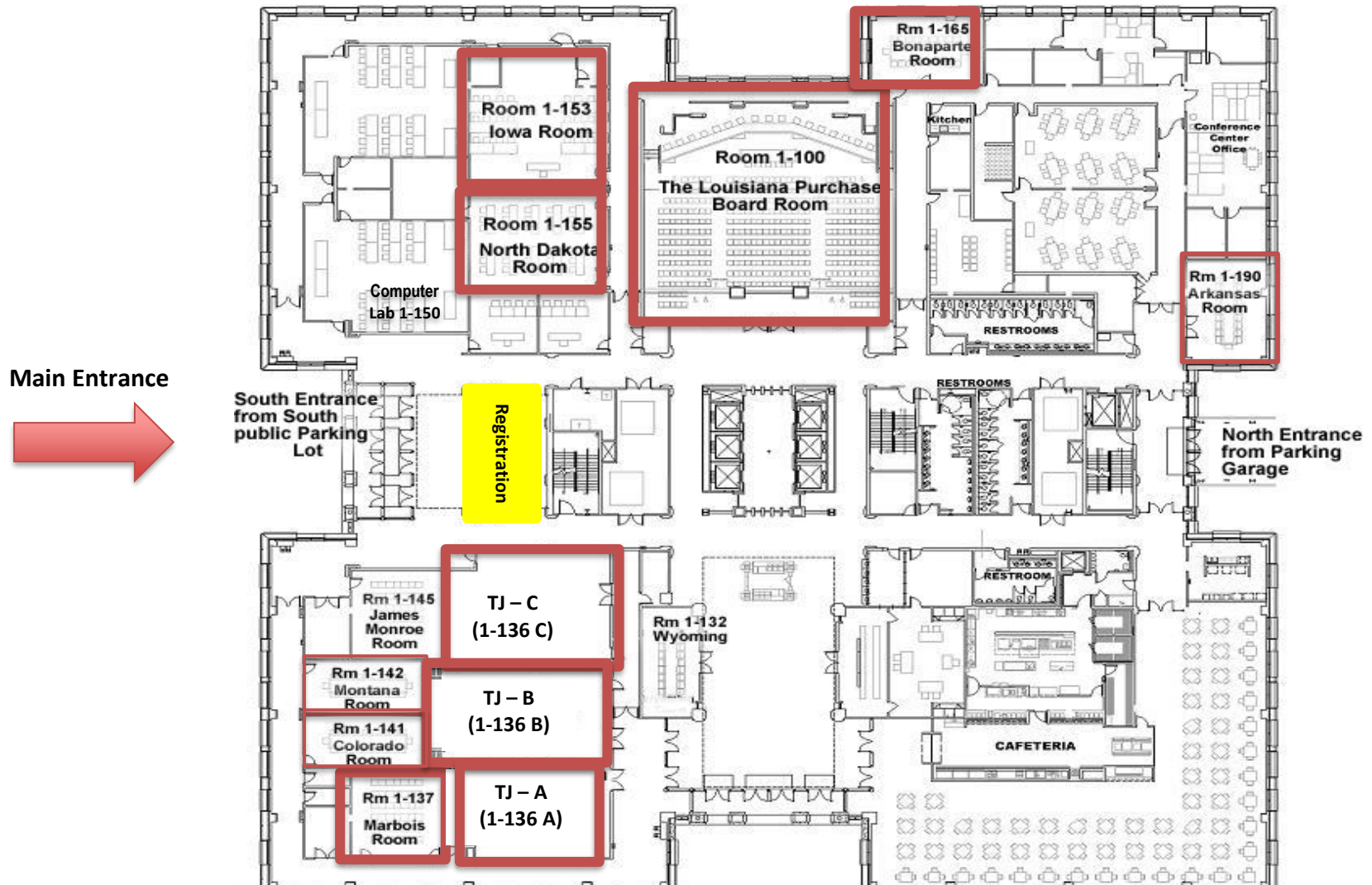

Note: All of the session information in this table is subject to change.